

Situated in the State of Ohio, County of Delaware, City of Powell and in Farm Lot 25, Quarter Township 4, Township 3, Range 19, United States Military Lands, containing 10.680 acres of land, more or less, said 10.680 acres being comprised of part (2.160 acres) that tract of land conveyed to M/I SCHOTTENSTEIN HOMES, INC. by deed of record in Deed Book 656, Page 170 and part (8.520 acres) of that tract of land conveyed to M/I SCHOTTENSTEIN HOMES, INC. by deed of record in Deed Book 656, Page 173, Recorder's Office, Delaware County, Ohio.

The undersigned, M/I SCHOTTENSTEIN HOMES, INC., an Ohio corporation, by PAUL S. COPPEL, President Land Operations/General Counsel, owner of the land platted herein, duly authorized in the premises, does hereby certify that this plat correctly represents its "THE LAKES OF POWELL SECTION 6 PART 2", a subdivision containing lots numbered 2575 to 2602, both inclusive, does hereby accept this plat of same and dedicates to public use, as such, all of Lot 2602 and all of the Drive and Street shown hereon and not heretofore dedicated.

Easements are hereby reserved, in over and under areas designated on this plat as "Easement" or "Drainage Easement" for the construction, operation and maintenance of all public and quasi public utilities above and beneath the surface of the ground and, where necessary, for the construction, operation and maintenance of service connections to all adjacent lots and lands and for storm water drainage. Within those areas designated "Drainage Easement" on this plat, an additional easement is hereby reserved for the purpose of constructing, operating and maintaining major storm water drainage swales and/or other storm water drainage facilities. No above grade structures, dams or other obstructions to the flow of storm water runoff are permitted within Drainage Easement areas as delineated on this plat unless approved by the Powell City Engineer.

A nonexclusive easement is hereby specifically granted to Del-Co Water Company, Inc., its successors and assigns, for the location of water lines, valves and appurtenances within the road rights-of-way dedicated hereon and within areas alongside said road rights-of-way designated hereon as "Easement" or "Drainage Easement". Also granted is the right of Del-Co Water Company, Inc. to install, service and maintain water meter crocks and appurtenances in said easement areas alongside said road rights-of-way.

In Witness Whereof, PAUL S. COPPEL, President Land Operations/General Counsel of M/I SCHOTTENSTEIN HOMES, INC., has hereunto set his hand this ___ day of ___, 2001.

Signed and acknowledged
in the presence of:

M/I SCHOTTENSTEIN HOMES, INC.

By
PAUL S. COPPEL,
President Land Operations/
General Counsel

STATE OF OHIO
COUNTY OF FRANKLIN ss:

Before me, a Notary Public in and for said State, personally appeared PAUL S. COPPEL, President Land Operations/General Counsel of M/I SCHOTTENSTEIN HOMES, INC., who acknowledged the signing of the foregoing instrument to be his free and voluntary act and deed and the free and voluntary act and deed of said M/I SCHOTTENSTEIN HOMES, INC. for the uses and purposes expressed therein.

In Witness Thereof, I have hereunto set my hand and affixed my official seal this ___ day of ___, 2001.

My commission expires _____
Notary Public, State of Ohio

Approved this ___ day of ___, 2001
Mayor, City of Powell, Ohio

Approved this ___ day of ___, 2001
City Engineer, City of Powell, Ohio

Approved this ___ day of ___, 2001
Chairman, Planning and Zoning Commission, City of Powell, Ohio

Approved and accepted this ___ day of ___, 2001, by Ordinance No. _____ wherein Lot 2602, and all of the Drive and Street hereby dedicated are accepted as such, by the Council, for the City of Powell, Ohio.

In Witness Thereof I have hereunto set my hand and affixed my seal this ___ day of ___, 2001.
Clerk, City of Powell, Ohio

Transferred this ___ day of ___, 2001.
Auditor, Delaware County, Ohio

Filed for record this ___ day of ___, 2001 at ___ M. Fee \$ ____
File No. _____
Recorder, Delaware County, Ohio

Cabinet ___ Slides _____

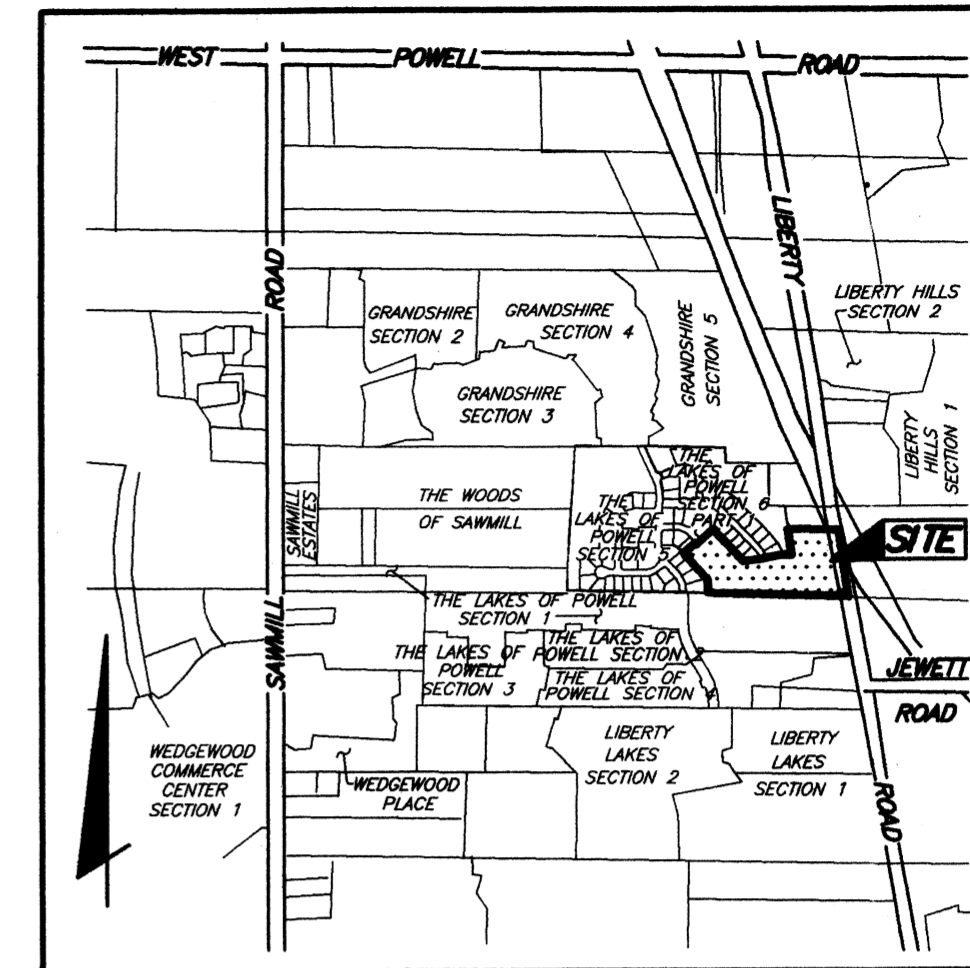

LOCATION MAP AND BACKGROUND DRAWING
SCALE: 1"=1500'

SURVEY DATA:

BASIS OF BEARINGS: The bearings shown on this plat are based on the same meridian as the bearings shown on the subdivision plat entitled "Wedgewood Commerce Center Section 1" of record in Cabinet 1, Slides 338 through 338G, Recorder's Office, Delaware County, Ohio.

SOURCE OF DATA: The sources of recorded survey data are the records of the Delaware County, Ohio, Recorder referenced in the plan and text of this plat.

IRON PINS, where indicated, unless otherwise noted, are to be set and are iron pipes, thirteen-sixteenths inch inside diameter, thirty inches long with a plastic plug placed in the top end bearing the initials E.M.H. & T. INC.

PERMANENT MARKERS: Permanent markers, where indicated hereon, are to be one-inch diameter, thirty-inch long, solid iron pins, are to be set to monument the points indicated and are to be set with the top end flush with the surface of the ground and then capped with an aluminum cap stamped "EMHT INC". Once installed, the top of the cap shall be marked (punched) to record the actual location of the point.

SURVEYED & PLATTED
BY
EMHT
CONSULTING ENGINEERS & SURVEYORS
GAHANNA, OHIO 43230

We do hereby certify that we have surveyed the above premises, prepared the attached plat, and that said plat is correct. All dimensions are in feet and decimal parts thereof. Dimensions shown on curves are chord measurements.

● = MAG Nail to be set Metric Conversion 1ft.=0.30480m
○ = Iron Pin (See Survey Data) ⊙ = Permanent Marker (See Survey Data)

By _____ Professional Surveyor No. 7211 Date _____

THE LAKES OF POWELL SECTION 6 PART 2

EXHIBIT
ORDINANCE
2001-67