

A GIANT EAGLE EXPANSION SITE PLAN
 SCALE: 1" = 60'-0"

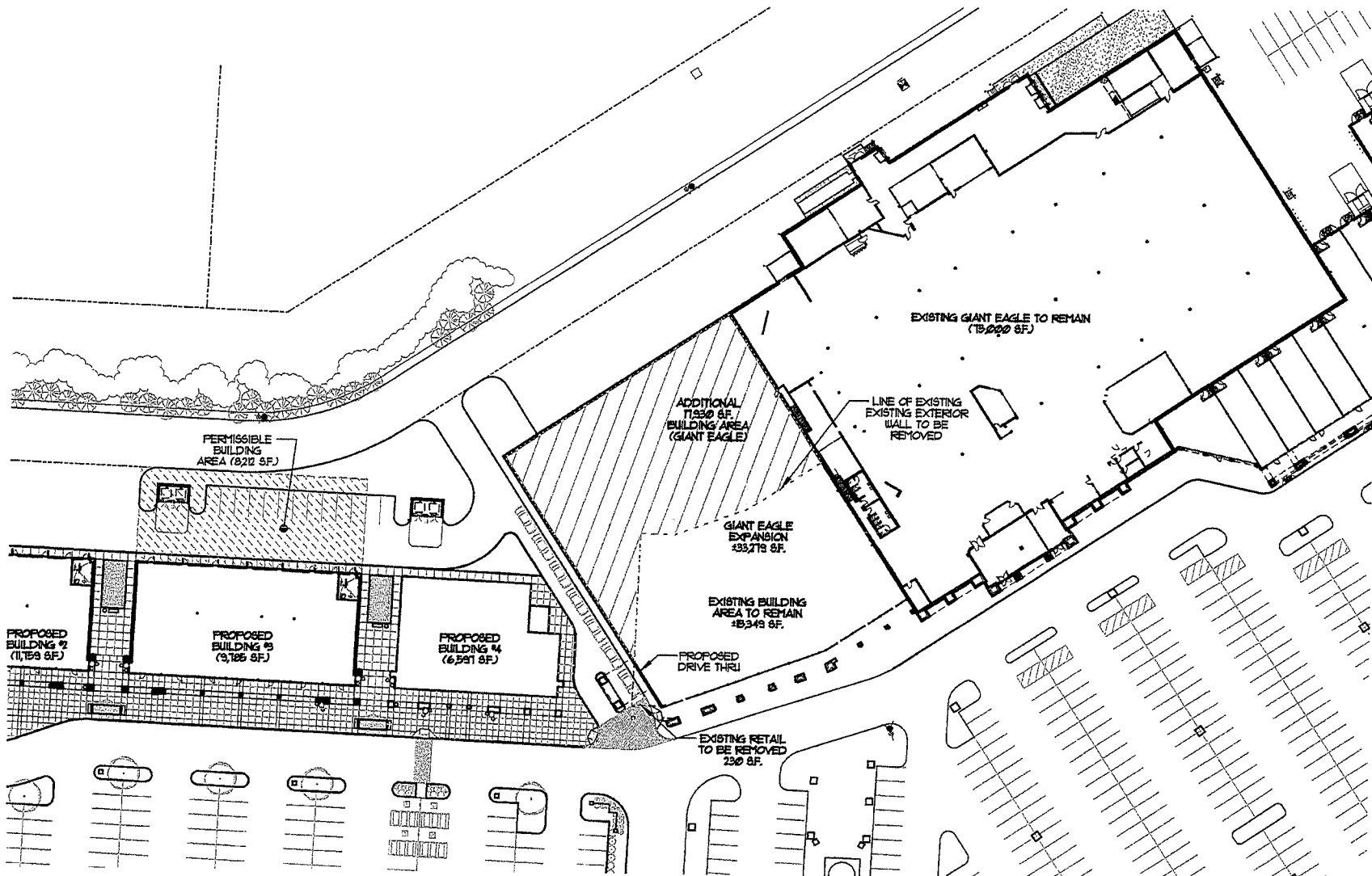

FORD & ASSOCIATES		ARCHITECTS	1500 WEST FIRST AVENUE COLUMBUS, OHIO 43212 614.488.6252 614.488.6963 (Fax)
THE MARKET AT LIBERTY CROSSING POWELL ROAD AND SAWMILL PARKWAY			
PROJECT NUMBER	0828.00	FOR MARKET AT LIBERTY CROSSING, LLC 26900 WEST ELEVEN MILE ROAD, SUITE 200, SOUTHFIELD, MI 48034	
DATE	MAR. 27, 2009	SHEET NO.	
			E-1



A GIANT EAGLE EXPANSION SITE PLAN
 SCALE: 1" = 60'-0"

THE MARKET AT LIBERTY CROSSING POWELL ROAD AND SAWMILL PARKWAY	
PROJECT NUMBER 09282.00	DATE MAR. 27, 2009
SHEET NO. E-2	
FOR MARKET AT LIBERTY CROSSING, LLC. 25800 WEST ELEVEN MILE ROAD, SUITE 200, SOUTHFIELD, MI 48034	
FORD & ASSOCIATES ARCHITECTS	1600 WEST FIRST AVENUE COLUMBUS, OHIO 43212 614.488.8252 614.488.8833 (Fax)

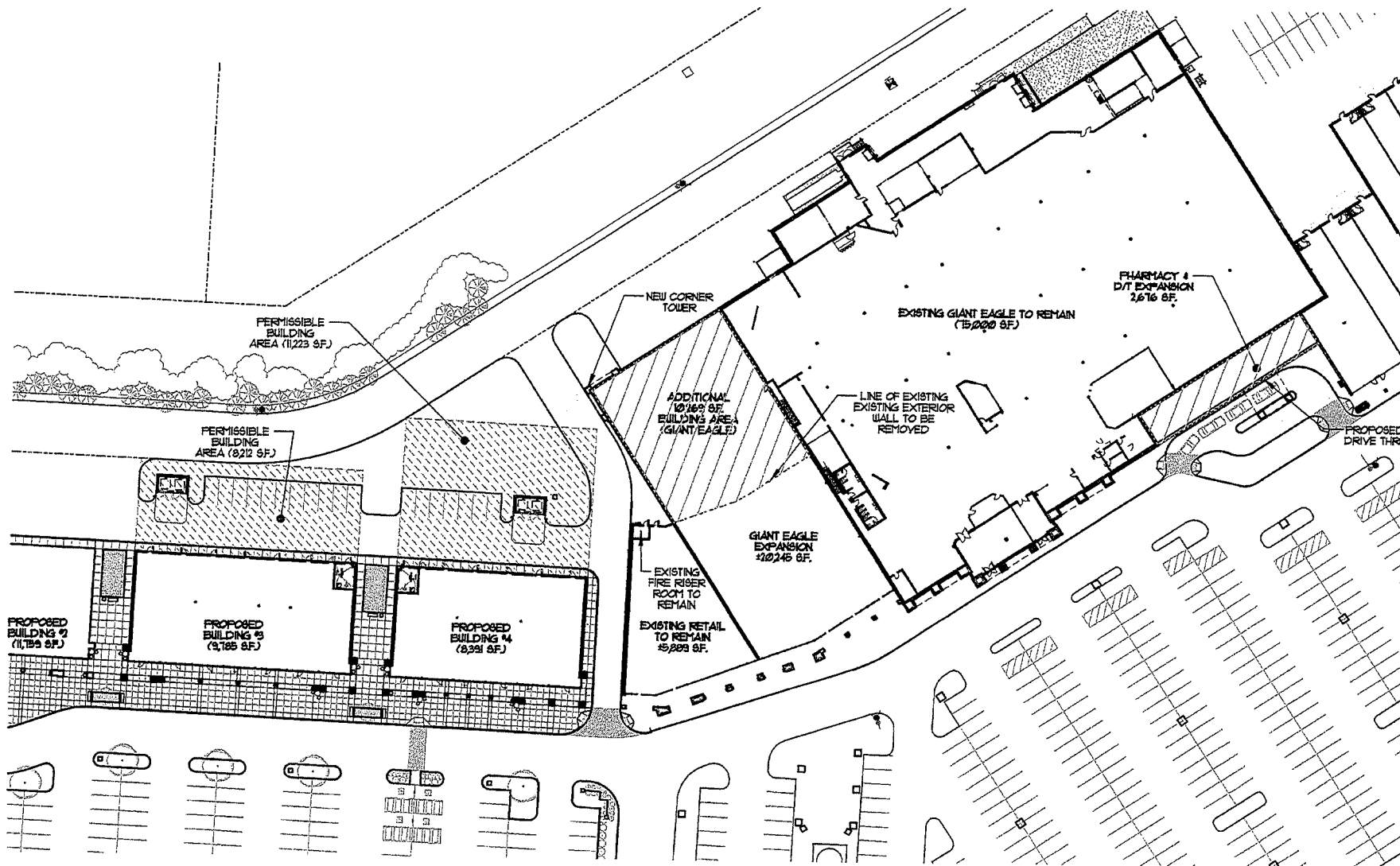

A GIANT EAGLE EXPANSION SITE PLAN
 SCALE: 1" = 60'-0"



THE MARKET AT LIBERTY CROSSING POWELL ROAD AND SAWMILL PARKWAY		PROJECT NUMBER: 08228.00	DATE: MAR. 27, 2009	E-3
FOR MARKET AT LIBERTY CROSSING, LLC. 25800 WEST ELEVEN MILE ROAD, SUITE 200, SOUTHFIELD, MI 48034		SHEET NO.		
FORD & ASSOCIATES ARCHITECTS 1500 WEST FIRST AVENUE COLUMBUS, OHIO 43212 614.488.6752 614.488.9983 (Fax)				

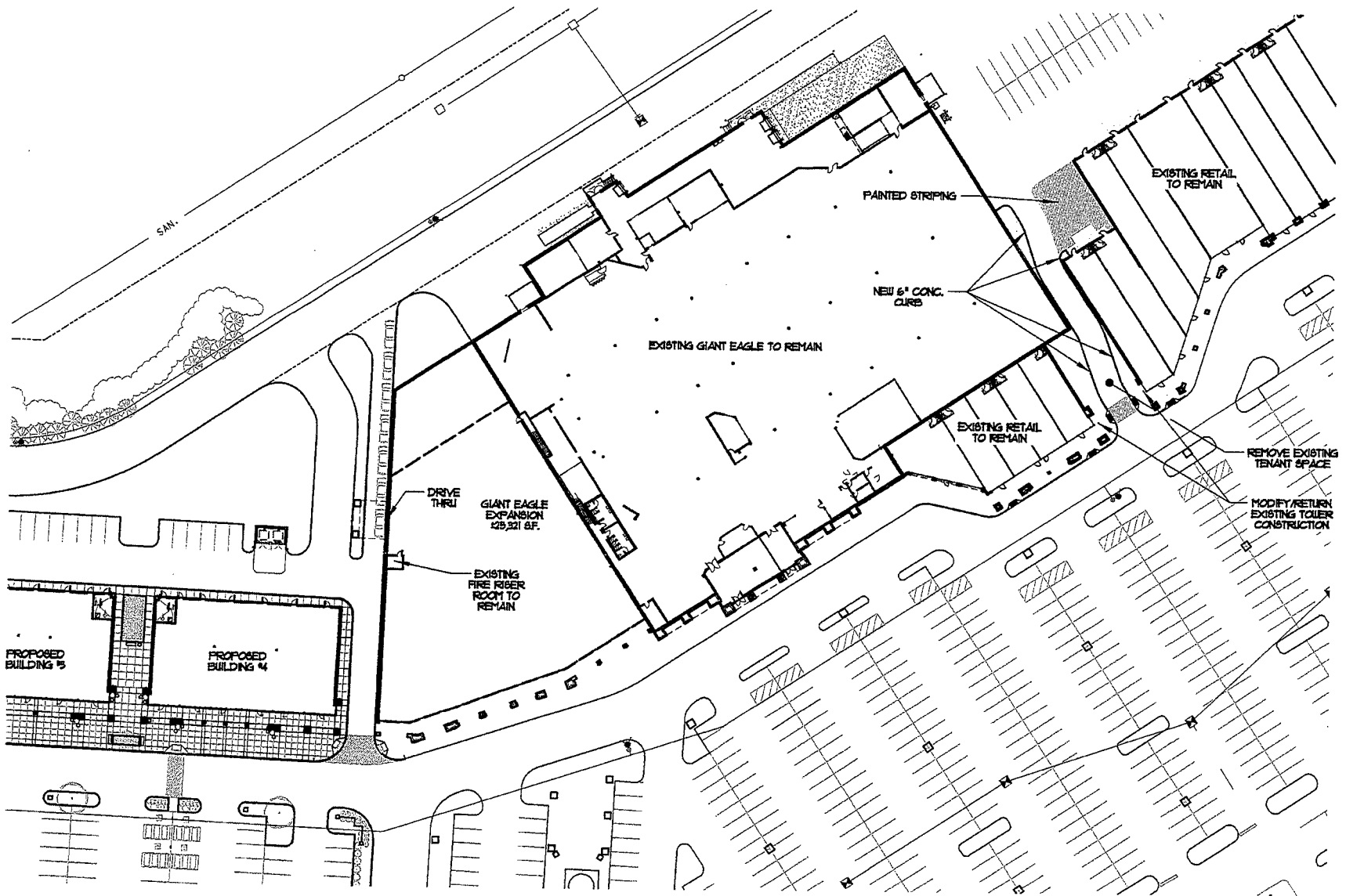

A GIANT EAGLE EXPANSION SITE PLAN
 SCALE: 1" = 60'-0"

Z:\Voyett\Market @ Liberty Crossing\Annexation\oddendun drawings\E-4.dgn 3/27/2009 10:59:14 AM

PROJECT NUMBER	08128.00
DATE	MAR 27, 2009
SHEET NO.	E-4

THE MARKET AT LIBERTY CROSSING
 POWELL ROAD AND SAWMILL PARKWAY

FOR
MARKET AT LIBERTY CROSSING, LLC.
 23800 WEST ELEVEN MILE ROAD, SUITE 200, SOUTHFIELD, MI 48034

FORD & ASSOCIATES	
ARCHITECTS	
1500 WEST FIRST AVENUE COLUMBUS, OHIO 43212 614.488.6252 (Fax) 614.488.9983 (Fax)	



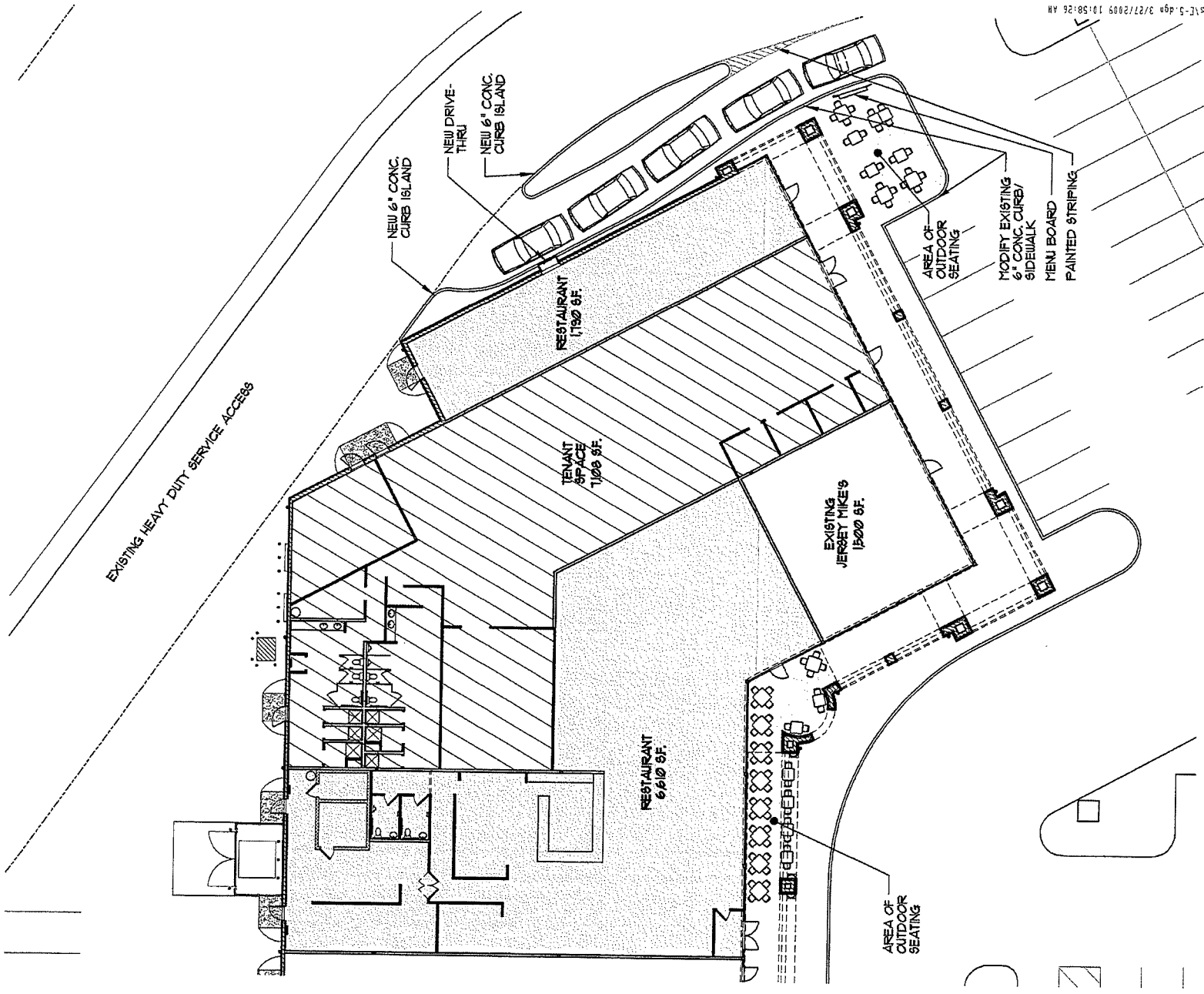

Z:\Project\Market & Liberty Crossing\Market\external\addendum drawings\1-5.dgn 3/27/2009 10:58:26 AM



A EAST WING REDEVELOPMENT
SCALE: 1" = 20'-0"

FORD & ASSOCIATES ARCHITECTS 1500 WEST FIRST AVENUE COLUMBUS, OHIO 43212 614.483.9922 (Fax)	THE MARKET AT LIBERTY CROSSING POWELL ROAD AND SAWMILL PARKWAY		PROJECT NUMBER 0828.00
	FOR MARKET AT LIBERTY CROSSING, LLC. 25800 WEST ELEVEN MILE ROAD, SUITE 250, SOUTHFIELD, MI 48034		DATE MAR. 27, 2009
			SHEET NO. E-5

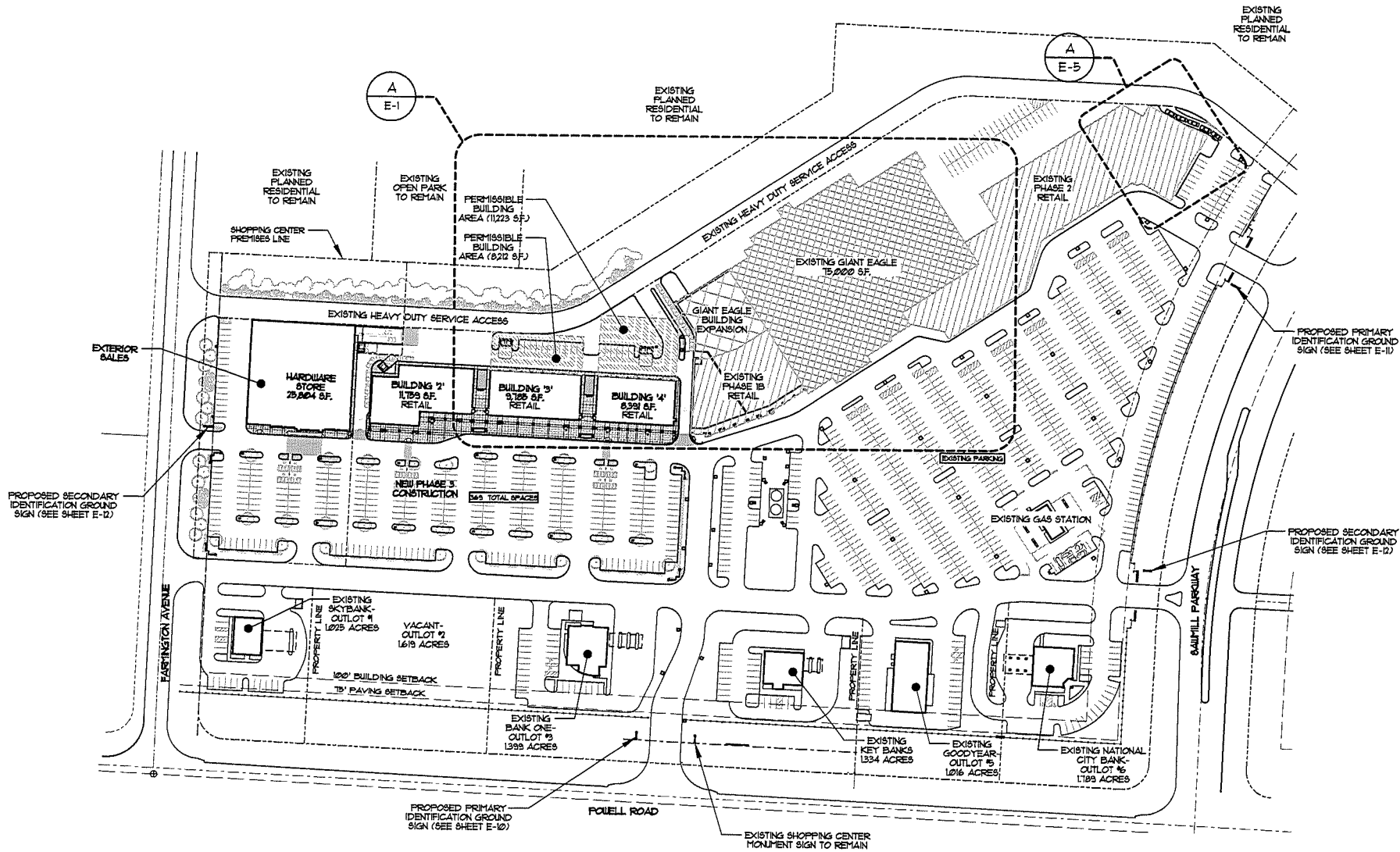

A

PROPOSED SITE DEVELOPMENT PLAN

SCALE: 1" = 150'-0"

FORD & ASSOCIATES ARCHITECTS 1500 WEST FIRST AVENUE COLUMBUS, OHIO 43212 614.468.6952 614.468.6953 (fax)	PROJECT NUMBER: 08128.00 DATE: MAR. 28, 2010 SHEET NO.: E-6
	THE MARKET AT LIBERTY CROSSING POWELL ROAD AND SAWMILL PARKWAY FOR MARKET AT LIBERTY CROSSING, LLC. 25900 WEST ELEVEN MILE ROAD, SUITE 250, SOUTHFIELD, MI 48034

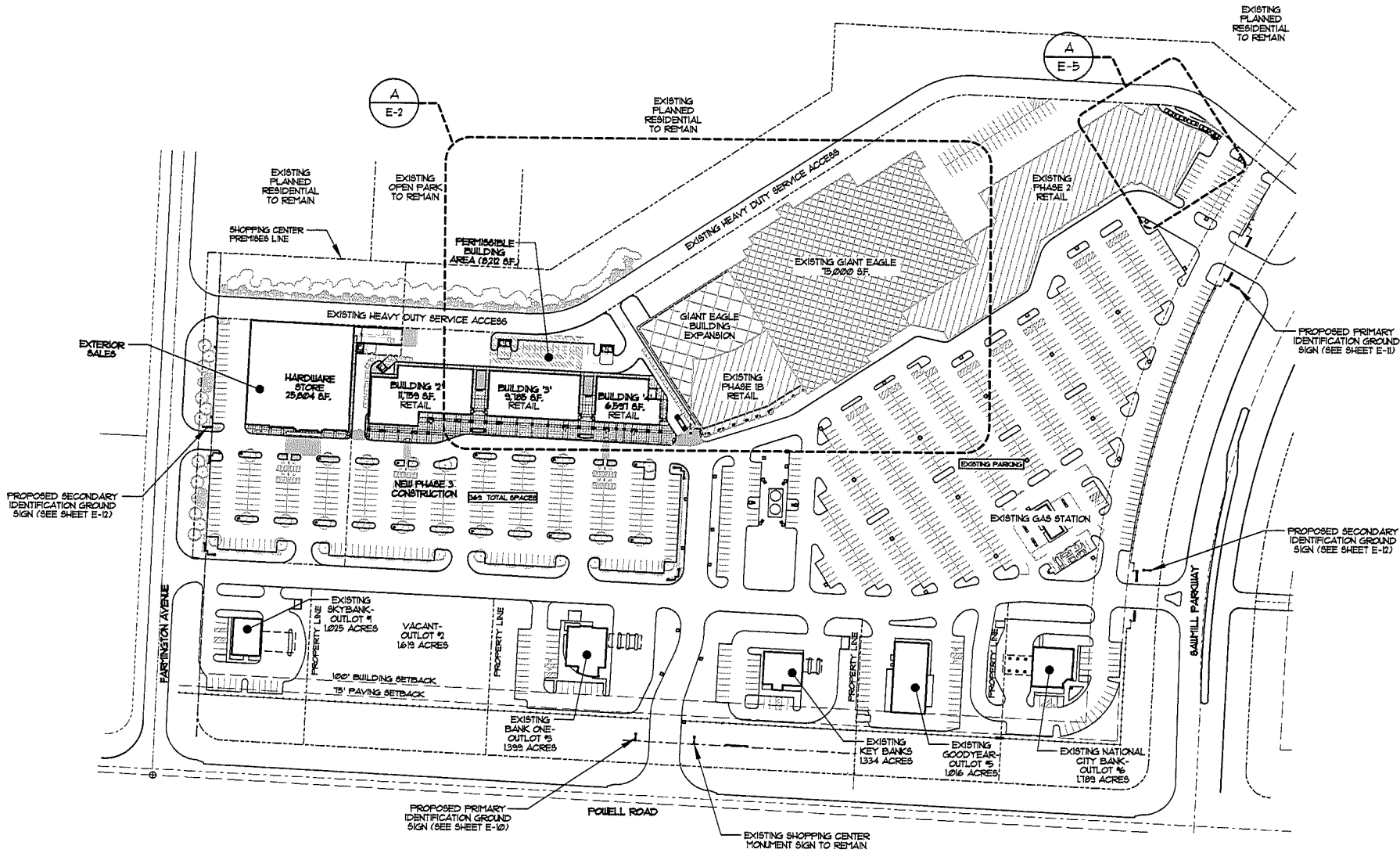

A PROPOSED SITE DEVELOPMENT PLAN

SCALE: 1" = 150'-0"

FORD & ASSOCIATES ARCHITECTS 1500 WEST FIRST AVENUE COLUMBUS, OHIO 43212 614-466-6632 (Fax) 614-466-6965 (Fax)	PROJECT NUMBER 08128.00	DATE MAR. 28, 2010	SHEET NO. E-7
	THE MARKET AT LIBERTY CROSSING POWELL ROAD AND SAWMILL PARKWAY FOR MARKET AT LIBERTY CROSSING, LLC. 28900 WEST ELEVEN MILE ROAD, SUITE 250, SOUTHFIELD, MI 48034		

THE MARKET AT LIBERTY CROSSING
POWELL ROAD AND SAWMILL PARKWAY

FOR
MARKET AT LIBERTY CROSSING, LLC.
 25900 WEST ELEVEN MILE ROAD, SUITE 250, SOUTHFIELD, MI 48034

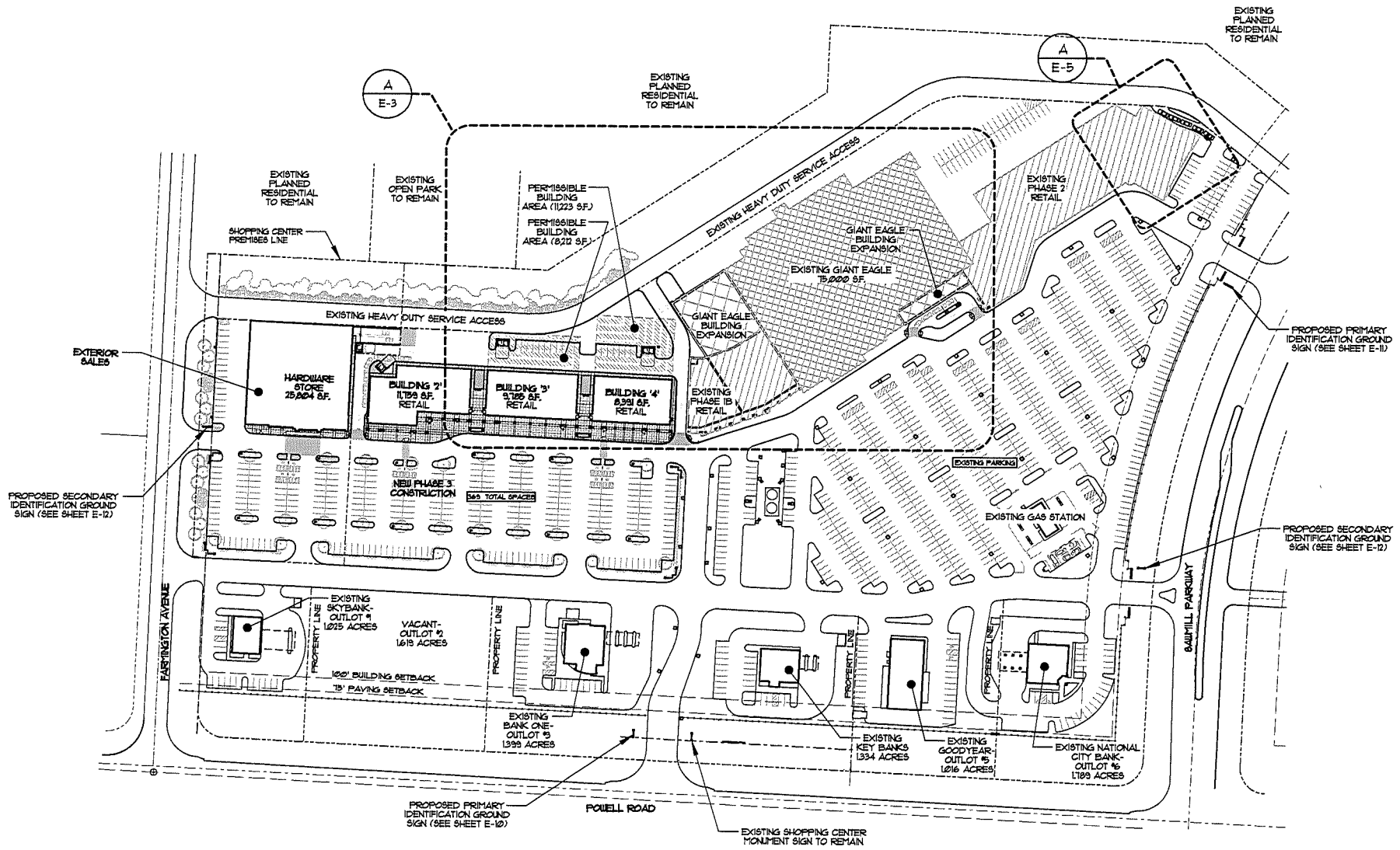

A **PROPOSED SITE DEVELOPMENT PLAN**
 SCALE: 1" = 150'-0"



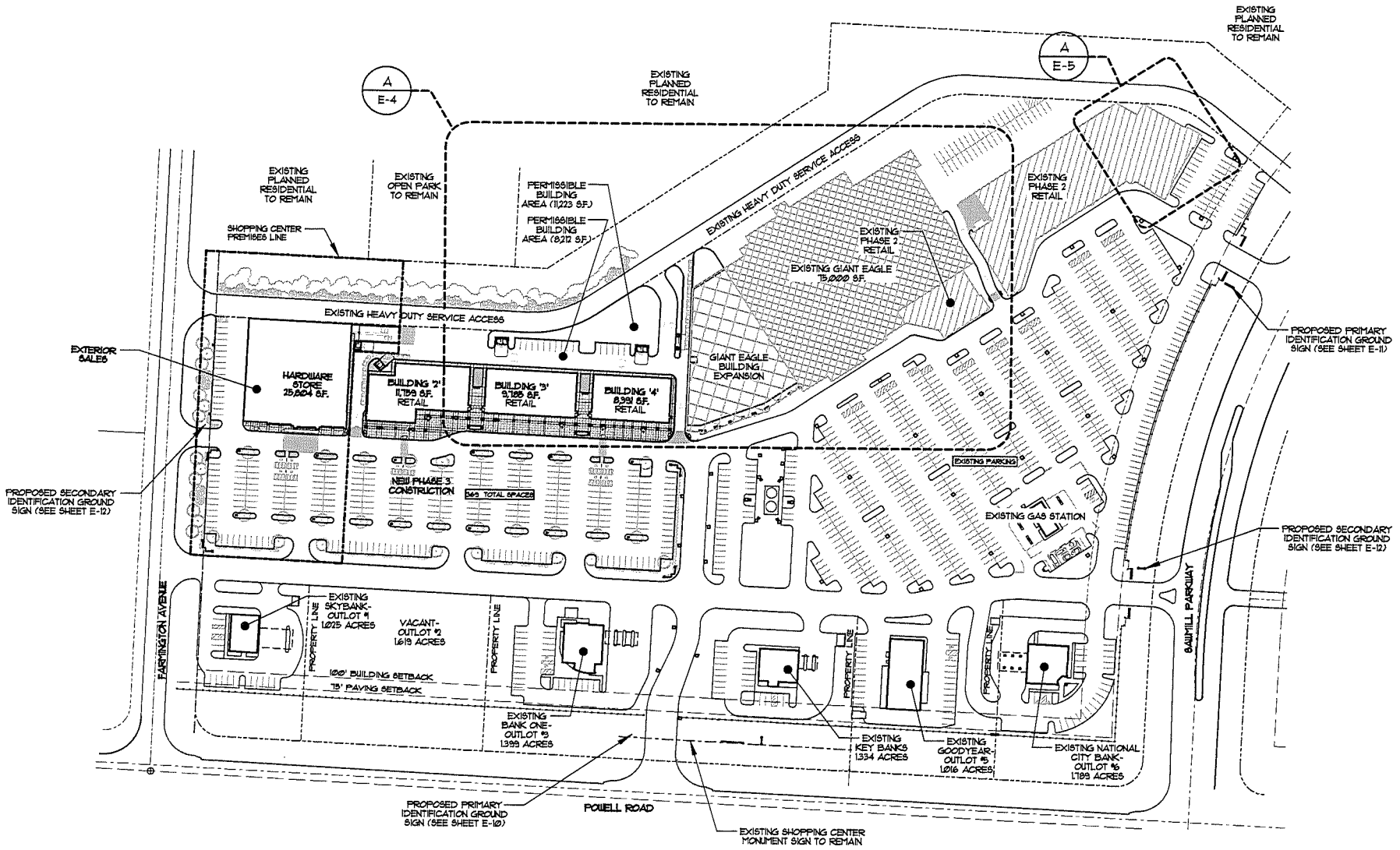

A

PROPOSED SITE DEVELOPMENT PLAN

SCALE: 1" = 150'-0"



FORD & ASSOCIATES ARCHITECTS 1500 WEST FIRST AVENUE COLUMBUS, OHIO 43212 614.488.6252 614.488.9893 (Fax)	PROJECT NUMBER: 082800 DATE: MAR. 28, 2010 SHEET NO.: E-9
	THE MARKET AT LIBERTY CROSSING POWELL ROAD AND SAWMILL PARKWAY FOR MARKET AT LIBERTY CROSSING LLC 25800 WEST ELEVEN MILE ROAD, SUITE 250, SOUTHWELD, MI 48034

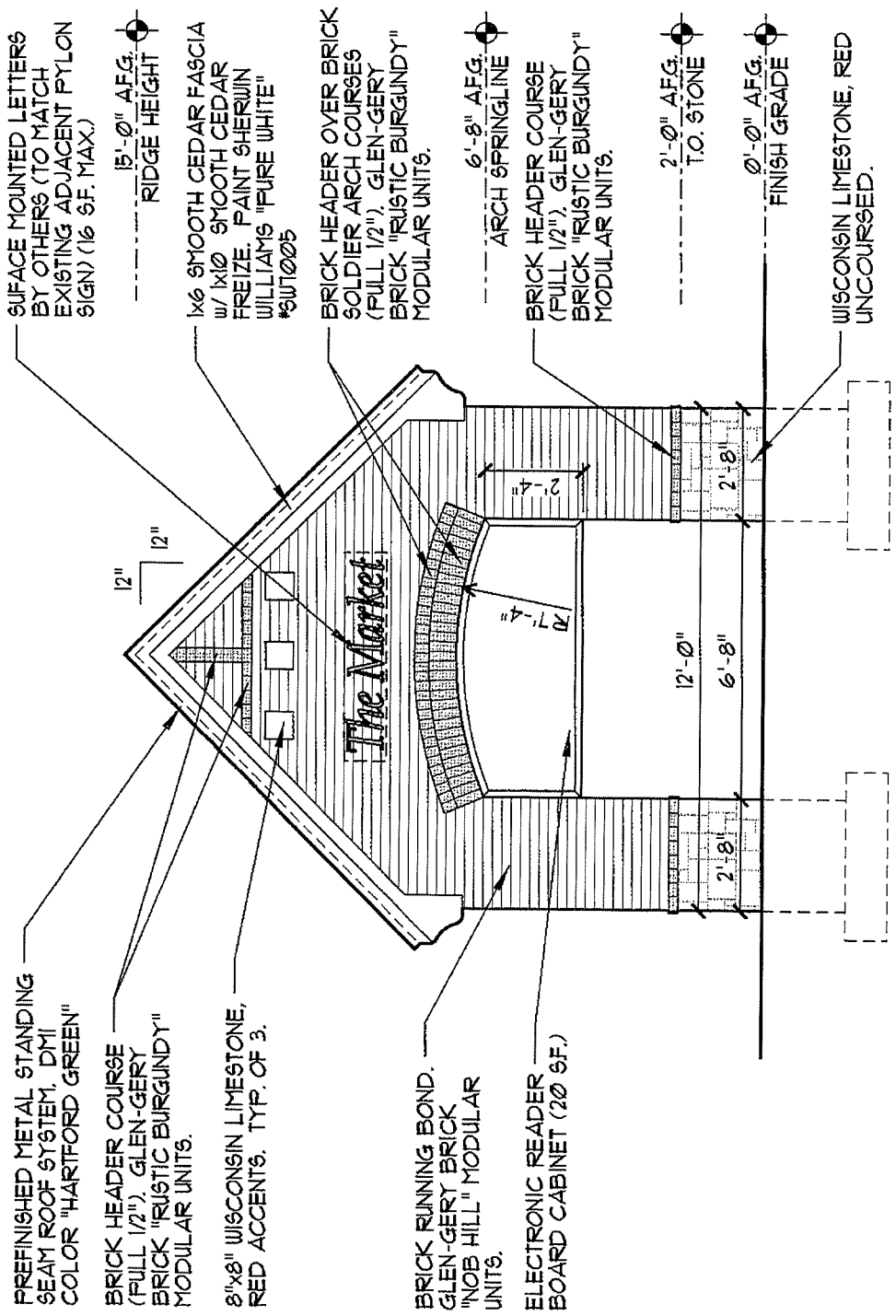

PREFINISHED METAL STANDING SEAM ROOF SYSTEM, DMI COLOR "HARTFORD GREEN"

BRICK HEADER COURSE (FULL 1/2") GLEN-GERY BRICK "RUSTIC BURGUNDY" MODULAR UNITS.

8"x8" WISCONSIN LIMESTONE, RED ACCENTS, TYP. OF 3.

BRICK RUNNING BOND, GLEN-GERY BRICK "NOB HILL" MODULAR UNITS.

ELECTRONIC READER BOARD CABINET (20 SF.)

SURFACE MOUNTED LETTERS BY OTHERS (TO MATCH EXISTING ADJACENT PYLON SIGN) (16 SF. MAX.)

15'-0" A.F.G. RIDGE HEIGHT

1x6 SMOOTH CEDAR FASCIA w/ 1x10 SMOOTH CEDAR FREIZE, PAINT SHERWIN WILLIAMS "PURE WHITE" #SUT1005

BRICK HEADER OVER BRICK SOLDIER ARCH COURSES (FULL 1/2"), GLEN-GERY BRICK "RUSTIC BURGUNDY" MODULAR UNITS.

6'-8" A.F.G. ARCH SPRINGLINE

BRICK HEADER COURSE (FULL 1/2"), GLEN-GERY BRICK "RUSTIC BURGUNDY" MODULAR UNITS.

2'-0" A.F.G. T.O. STONE

0'-0" A.F.G. FINISH GRADE

WISCONSIN LIMESTONE, RED UNCOURSED.

A

PRIMARY IDENTIFICATION GROUND SIGN

SCALE: 1/4" = 1'-0"

SIGN LOCATED AT POWELL ROAD ENTRY

FORD & ASSOCIATES ARCHITECTS 1500 WEST FIRST AVENUE COLUMBUS, OHIO 43212 614.488.6252 614.488.9963 (Fax)	THE MARKET AT LIBERTY CROSSING POWELL ROAD AND SAWMILL PARKWAY FOR MARKET AT LIBERTY CROSSING, LLC. 25900 WEST ELEVEN MILE ROAD, SUITE 250, SOUTHFIELD, MI 48034	MODIFIER SHEET: PROJECT NUMBER: 0812800 DATE: MAR. 27, 2008 SHEET NO:
	E-10	

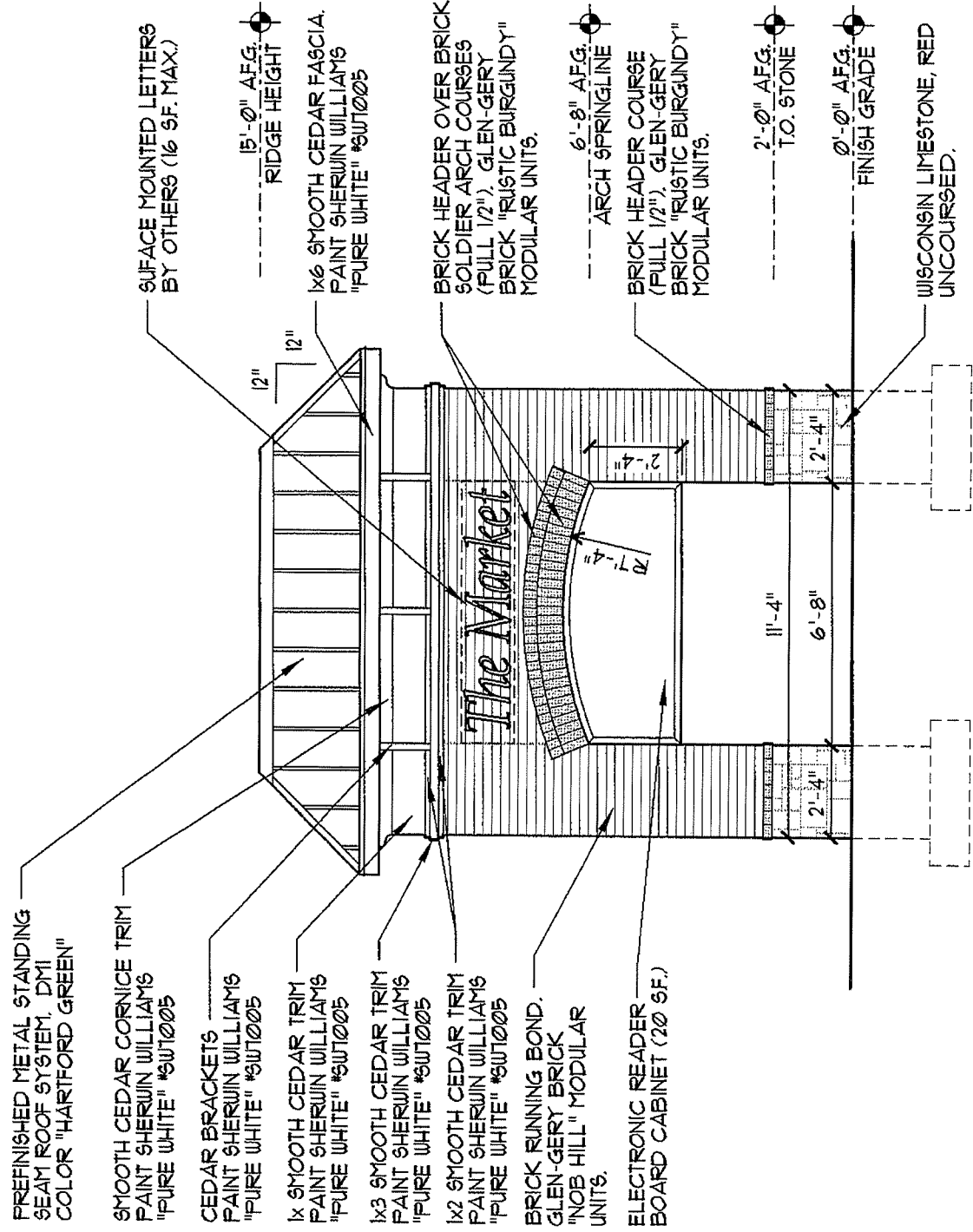

PRIMARY IDENTIFICATION GROUND SIGN

SCALE: 1/4" = 1'-0"

SIGN LOCATED AT SAWMILL PARKWAY ENTRY

FORD & ASSOCIATES
 ARCHITECTS
 1500 WEST FIRST AVENUE
 COLUMBUS, OHIO 43212
 614.488.6252
 614.488.9963 (Fax)

THE MARKET AT LIBERTY CROSSING
 POWELL ROAD AND SAWMILL PARKWAY
 FOR
MARKET AT LIBERTY CROSSING, LLC.
 25900 WEST ELEVEN MILE ROAD, SUITE 250, SOUTHFIELD, MI 48094

MOD/DES SHEET:	08128.00
PROJECT NUMBER:	08128.00
DATE:	MAR 27, 2009
SHEET NO.:	E-11

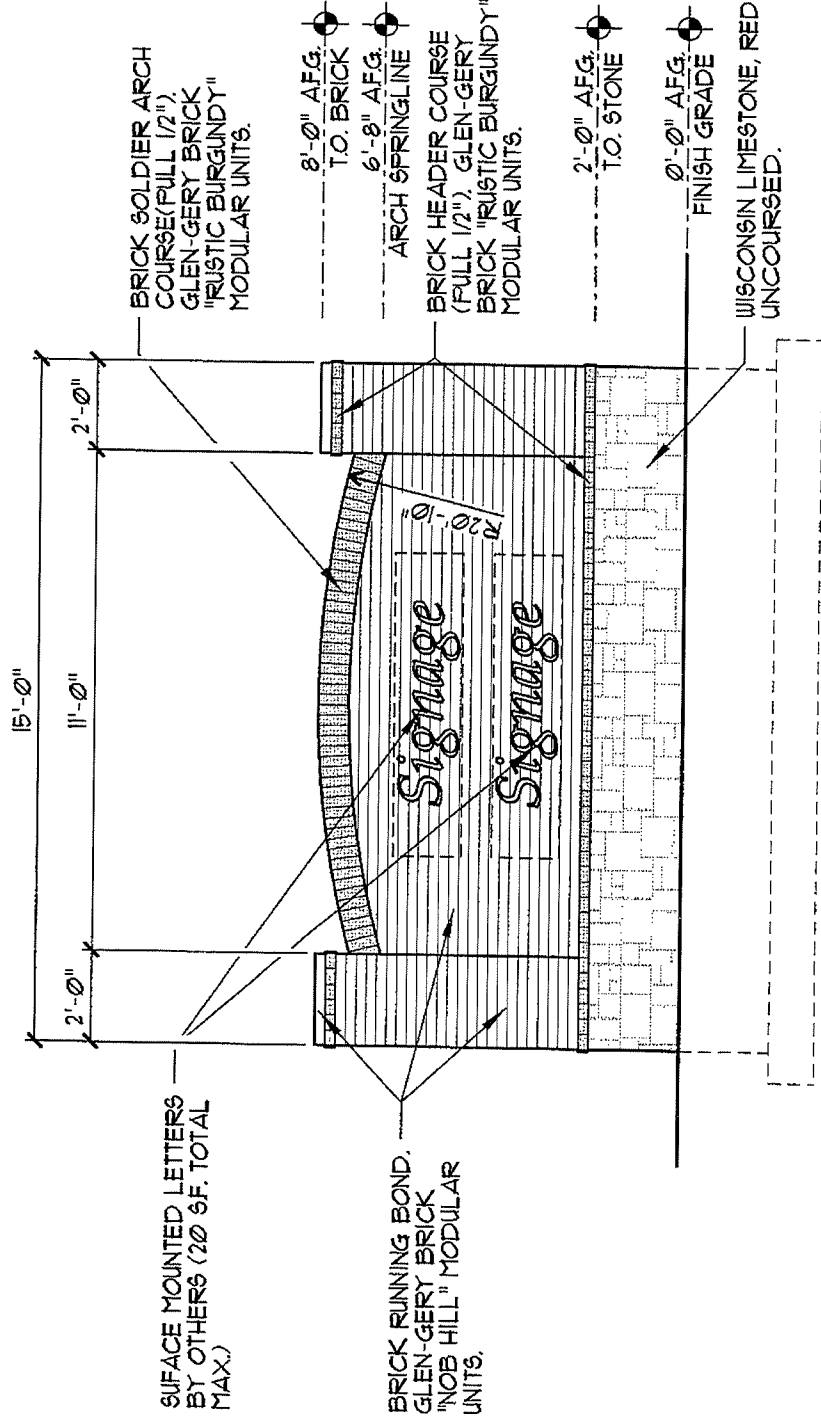

A SECONDARY IDENTIFICATION GROUND SIGN

SCALE: 1/4" = 1'-0"

SIGN LOCATED AT SAWMILL PARKWAY ENTRY

FORD & ASSOCIATES ARCHITECTS 1500 WEST FIRST AVENUE COLUMBUS, OHIO 43212 614.488.6252 614.488.9963 (Fax)	MODIFIES SHEET:
	PROJECT NUMBER: 06126.00
DATE: MAR 27, 2009	SHEET NO:
THE MARKET AT LIBERTY CROSSING POWELL ROAD AND SAWMILL PARKWAY FOR MARKET AT LIBERTY CROSSING, LLC. 25900 WEST ELEVEN MILE ROAD, SUITE 250, SOUTHFIELD, MI 48034	
E-12	